

<b>ASSA ABLOY</b>	<b>Product specification</b> <b>ASSA ABLOY RP300</b>	Doc.-No.	Seite 1
		Version 16 / 2019-01-31	
<b>Product specification</b>			

## PRODUCT SPECIFICATION

### ASSA ABLOY RP300

*Vertical rapid roll door*

#### Standard equipment

##### Dimensions:

Daylight width (DW):	750 - 4000 mm
Daylight height (DH):	750 - 3500 mm
Area:	0,56 – 14,00 m <sup>2</sup>
Wind class:	Class 1 according to EN 12424 (up to 11,00 m <sup>2</sup> )

Resistance to water penetration: -

Air permeability: -

Heat transition coefficient (U-value): -

Noise emission: < 70 dB A

Operating temperature: Standard +10 °C - +45 °C  
Extended 0°C - +60 °C (see "Allowed operating temperature range for ASSA ABLOY doors")

Door blade: RollTex Plus, Colors: Blue (RAL5002), Orange (RAL2009) or Grey (RAL7001), silicone-free  
(if not specified: Blue)

Side guides: Anodized aluminum, made of two pieces, without bottom plate, incl. stopper to prevent top position override

Safety switch: 1 Schmersal magnetic switch (Type1) on drive side, with safety control relay for safe detection of position door closed:  
Category 4, Performance Level e, according to EN ISO 13849-1, SIL3 according to IEC61508 and SILCL3 according to EN 62061.

Wind reinforcement: Wind tabs mounted at door blade sides

Top roll cover: Anodized aluminum; DH < 2300mm

Motor cover: Steel, powder coated (RAL9006)

Top roll: Aluminium Ø 115 mm with galvanized shafts

Bottom beam: Anodized aluminum; without break-away; with black/yellow warning signs; electrical self-testing safety edge, integrated in rubber profile; cable chain with pluggable connection inside side frame on drive side, with finger protection.  
(The flexible sealing lip protrudes 40mm into the daylight height).

Safety device: Photocell in door line

<b>ASSA ABLOY</b>	<b>Product specification</b> <b>ASSA ABLOY RP300</b>	Doc.-No.	Seite 2
		Version 16 / 2019-01-31	
<b>Product specification</b>			

Drive unit for ACS50:	GfA gear motor 0,75 kW with safety catching device, without pulse encoder (limit switches integrated in gearbox). Available for left and right side. (If not specified: right side)	
Emergency egress:	In case of power failure, the door can be opened by means of a crank.	
Control box:	ACS50 Electronic control system with mini contactors incl. black main switch, push-button up/down and stop button. Potential free contacts for open, close and failure. Must be used in combination with drive unit without pulse encoder. Cable length = 3m, other length as option, delivered with additional junction box. With Schmersal magnetic switch (Type1) cable length max. 7m.	
Opening/closing speed:	Max. 1.0 m/s / 1.0 m/s	
Power supply:	3/(N)/PE 230V (±10%), 50Hz,	10A fuse internal
	3/(N)/PE 380V (-5%/+10%), 50Hz,	6,3A fuse internal
	3/(N)/PE 400V (±10%), 50Hz,	6,3A fuse internal
	3/(N)/PE 415V (-10%/+5%), 50Hz,	6,3A fuse internal
Certificates:	Safe opening, peak forces according EN13241-1 Position switch in machine protection doors (EN ISO 13849-1, EN ISO 14120) Shot test - Safety of machine tools (DIN EN 13128) Internal pendulum test with shock energy absorption of E=441J. Tested in accordance with TRAV (Technical rules for use of anti-fall guard glazing)	
Marking:	External cable and component marking according to electrical drawing	
Cable ends:	All applicable cables are equipped with wire end sleeves	

## Optional equipment

Door blade alternative 1:	RollTex Original with/without windows. Colors: Orange (RAL2009), Blue (RAL5002) or Grey (RAL7001, also paintable on request), silicone-free Testet according to TRAV (Technical rules for use of anti-fall guard vitrification)	
Door blade alternative 2:	Nomatex Flame retardant door blade according to ISO 340 without vision panel or windows. Color: Grey (RAL7045), silicone-free	
Door blade alternative 3:	NomaTex with/without windows. With/without integrated vision panel (not replaceable), observe: visible width are DW-290mm but never more than 3110mm, silicone-free. Max. height of vision panel: WH<=750mm Color: E8/2 V1/V2 H Orange    RAL 2009    Antistatic, R < 3x10 <sup>8</sup> Ω E8/2 V1/V2 H Blue      RAL 5005    Antistatic, R < 3x10 <sup>8</sup> Ω E8/2 V1/V1 Grey*       RAL 7038    Antistatic, R < 3x10 <sup>8</sup> Ω E8/2 V1/V1 NA Yellow*   RAL 1023 E8/2 V1/V1 NA Red      RAL 3000 H= Smooth surface front side (top roll side) *Conforms to the requirements of FD (U.S. Food and Drug Administration) concerning the extraction behavior	

<b>ASSA ABLOY</b>	<b>Product specification</b> <b>ASSA ABLOY RP300</b>	Doc.-No.	Seite 3
		Version 16 / 2019-01-31	
<b>Product specification</b>			

Door blade alternative 4: Clear PVC (1,4 mm) with vertical colored stripes in PVC (0,5 mm)

Daylight width: 750 - 1270 mm: no vertical middle stripe

Daylight width: 1271 - 2400 mm: 1 vertical middle stripe

Daylight width: 2401 - 3500 mm: 2 vertical middle stripes

Daylight width: > 3500 mm: 3 vertical middle stripes

Colors for vertical and horizontal stripes (according to RAL):

Silicone-free (matt):

Blue (RAL 5010), Red (RAL 3002), Yellow (RAL 1021),

Orange (RAL 2011), White (RAL 9010), Grey (RAL 7037), Black (RAL 9005);

(If not specified: Blue)

Not silicone-free (glossy):

Blue (RAL 5002), Beige (RAL 1014), Green (RAL 6018), White (RAL 9016),

Grey (RAL 7035)

In cold positions or in positions with pressure differences door blade PVC should not be selected

Windows:  
(only for Rolltex  
and Nomatex)

vertical 500 x 700 mm (by  $DH \geq 1100$  mm):

Daylight width: 800 - 1700 mm: max. 1 window

Daylight width: 1701 - 2400 mm: max. 2 windows

Daylight width: 2401 - 3100 mm: max. 3 windows

Daylight width: > 3100 mm: max. 4 windows

horizontal 700 x 500 mm (by  $DH \geq 900$  mm):

Daylight width: 1000 - 2100 mm: max. 1 window

Daylight width: 2101 - 3000 mm: max. 2 windows

Daylight width: > 3000 mm: max. 3 windows

Window frame color in black or yellow

Window execution: Transparent or anti UV

Windows/ vision panel: Min. dimension from vision panel /Window level to bottom  $\geq 310$ mm

Top roll cover for

Std./Vario or chain drive: Anodized Aluminum;  $DH \geq 2300$ mm

Motor cover

Vario-Drive: Steel, powder coated (RAL9006) suitable for Vario and chain drive

Bottom beam:

Elongated sealing lip (electrical safety edge); extended by 50, 100 or 150mm

Elongated sealing lip (prerunning photocell); extended by 20mm

Bottom beam:

**Version A:** Anodized aluminum profile with flush transition to the curtain on side of operator; operator side = door side.  
Without break-away; with black/yellow warning signs on operator side.  
Electrical self-testing safety edge, integrated in rubber profile; alternative pre-running safety photocell. (The flexible sealing lip protrudes 40mm into the daylight height). Cable chain with pluggable connection inside side frame.

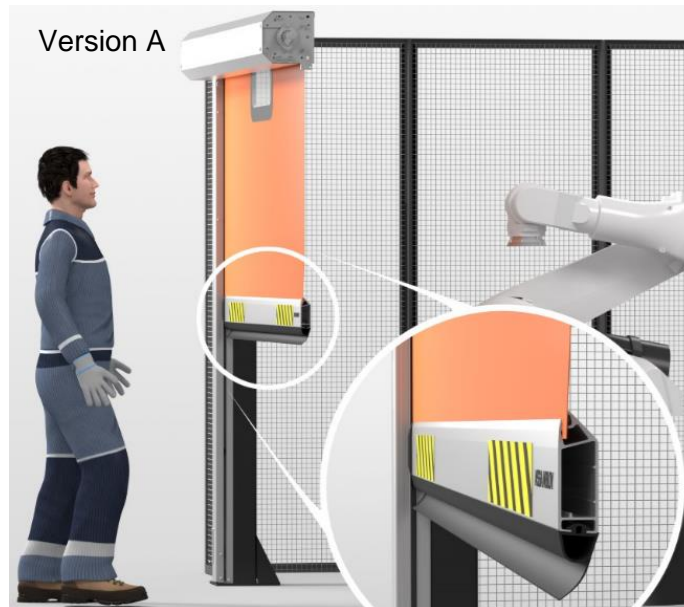

Bottom beam:

**Version B:** Not with ACS50. Anodized aluminum profile with flush transition to the curtain on side of operator; operator side is opposite of door side.  
Without break-away; with black/yellow warning signs on operator side.  
Electrical self-testing safety edge, integrated in rubber profile; alternative pre-running safety photocell. (The flexible sealing lip protrudes 40mm into the daylight height). Cable chain with pluggable connection inside side frame.

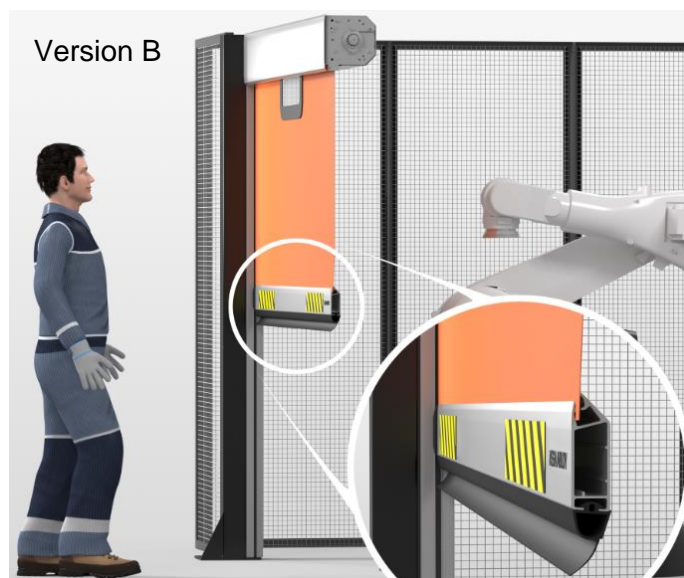

<b>ASSA ABLOY</b>	<b>Product specification</b> <b>ASSA ABLOY RP300</b>	Doc.-No.	Seite 5
		Version 16 / 2019-01-31	
<b>Product specification</b>			

Without photocell  
in door line:

For version with electrical safety edge; without photocell in door line. Only for use in automated processes, without CE-declaration of conformity.

Prerunning safety-  
photocell:

Prerunning safety photocell, with a cable chain with pluggable connection inside each side frame, for increased closing speed. Only available in combination with control system MCC. With door line photocell.

Opening- / Closing speed:

Max. 2,3 / 1,75 m/s; up to DW=2,5m x DH=2,5m

Max. 2,4 / 1,75 m/s; above DW=2,5m x DH=2,5m

Prerunning safety-  
photocell:

As above, but without door line photocell. Only for use in automated processes, without CE-declaration of conformity.

LED traffic light strip:

Mounting on external anodized aluminum bracket, 2 or 4 stripes selectable

X-Level:

The side guides for wall mounting, from the lower closing edge to the floor, can be produced up to a total length of max. 4,50m (DH + X).

Door supports:

Available for door height between min. 1,95m up to max. 3,60m  
(Combination with Chain drive or bottom plates is not possible)

Door supports  
with X-Level:

Available for door height between min. (DH + X) = 1,95m up to max.  
(DH + X) = 3,60m. (Combination with Chain drive or bottom plates is not possible)

<b>ASSA ABLOY</b>	<b>Product specification</b>	<b>Product specification</b>		Doc.-No.	Seite 6
		<b>ASSA ABLOY RP300</b>		Version 16 / 2019-01-31	

Safety switch:

	Schmersal Type1 (not with PROFIsafe)		Schmersal Type2 OSSD (only with PROFIsafe) (no safety control relay necessary)		Telemecanique (not with PROFIsafe)		Allen Bradley (not with PROFIsafe)	
	S = Standard; x = Option	safety category*	x = Option; - = not available	safety category*	x = Option	safety category*	x = Option; - = not available	safety category*
Control box	Without control system, ACS50, MCC		MCC		Without control system, ACS50, MCC		Without control system, ACS50, MCC	
1 switch <u>with</u> safety control relay (Drive-unit side)	S	PL. e Kat. 4 SIL 3	-	-	X	without	X	PL. e Kat. 4 SIL 3
1 switch <u>w/o</u> safety control relay (Drive-unit side)	X	without	X	PL. e Kat. 4 SIL 3	X	without	X	without
2 switch <u>with</u> safety control relay	X	PL. e Kat. 4 SIL 3	-	-	X	PL. d Kat. 3 SIL 3	-	-
2 switches <u>w/o</u> safety control relay	X	without	X	PL. e Kat. 4 SIL 3	X	without	-	-
<i>Doors with safety limit switches also contain the actuator and required cabling</i>								
Prepared for 1 switch (Drive-unit side)	X	without	-	-	X	without	X	without
Prepared for 2 switches	X	without	-	-	X	without	-	-
<i>Prepared = with bracket for sensor and actuator, without cable</i>								
Window in cover profile	X	X	X	X	X	X	X	X
Without safety switch	without brackets, without preparation		not available		without brackets, without preparation			

\* Safety category: performance level (PL) / category according EN ISO 13849-1 and SIL3 (safety integrity level) according IEC61508.

Bottom plates: With bottom plates

Door without Safety switch: Without safety switch, with black/yellow warning signs on bottom beam

Vario-Drive: Motor MCC / ACS50 can be turned in steps of 45°. Left and right hand available (if not specified: right side)

<b>ASSA ABLOY</b>	<b>Product specification</b> <b>ASSA ABLOY RP300</b>	Doc.-No.	Seite 7
		Version 16 / 2019-01-31	
<b>Product specification</b>			

Chain drive:	Chain drive box with drive MCC / ACS50, can be turned in steps of 45°, position vertically downwards (0°) and 315° not possible. In addition the Vario-drive can be turned in steps on 45° relative to the chain drive box. Available for left and right hand side. (If not specified: right side) In total 56 different combinations of chain drive/Vario-drive positions. Combination with Door supports is not possible
Hand chain operator:	KNH Hand chain operator. Easy, manually emergency opening by power failure. Combination with Motor covers is not possible.
Drive unit MCC:	GfA gear motor 0,75 kW with safety catching device and pulse encoder. (Reference integrated in gearbox). Available for left and right hand side. (If not specified: right side)
Drive:	UL-Version GfA gear motor 0,75 kW with safety catching device. Not available with UPS.
Control box:	Frequency converter MCC Vector Control, Opening / Closing speed: Max. 2,3 / 1,4 m/s; up to DW=2,5m x DH=2,5m Max. 2,4 / 1,3 m/s; above DW=2,5m x DH=2,5m  Control system mounted on side frame under drive unit. Cable length between drive unit and control system = 1 m MCC extension with terminal block or optional interface card and, when applicable, safety relay are supplied separately. Cable length >= daylight height (available in steps of 3, 4½, 7, 10, 15, 30m) Surface mounted main switch with black handle, cable length >= daylight height (available in steps of 3, 4½, 7, 10, 15, 30m)  Prepared for MCC Display with (no display unit delivered as standard), cable with plug inside side frame
Display:	Display unit with buttons for open / stop / down for MCC control system. Necessary for setup/ initiation. Not necessary in normal door operation. One display can be moved and connected to any door with MCC when the need arise. Display unit mounted on the side frame depends on Daylight Height: 1250-1999mm: just on <u>non</u> Control side; Display app.1340mm from bottom 2000-2299mm: available for both sides; Display app.1210mm from bottom 2300- mm: available for both sides; Display app.1510mm from bottom By Door with X-Level Display position would be higher for the value X. Display unit for wall mounting; cable available in length 3, 4½, 7, 10, 15, 30m
Combi Box MCC:	Interface card / main switch with black handle and, when applicable safety relay, mounted in a plastic box. Dimension 175x250x150 mm. Cable available in length 3, 4½, 7, 10, 15, 30m with bracket and cable channel if door is delivered with door support (column) and with MCC at side frame and without MCC display and if plastic combi Box on drive side.
Metal combi Box MCC:	Interface card / main switch with black handle and, when applicable safety relay, mounted in a metal box. Dimension 200x300x155 mm. Cable available in length 3, 4½, 7, 10, 15, 30m With bracket and cable channel if door is delivered with door support (column) and with MCC at side frame and without MCC display and if metal combi Box on drive side.

<b>ASSA ABLOY</b>	<b>Product specification</b> <b>ASSA ABLOY RP300</b>	Doc.-No.	Seite 8
		Version 16 / 2019-01-31	
<b>Product specification</b>			

Extensionbox MCC:	Integrated terminal block (Extension card optional) / when applicable safety relay, mounted in an extension of the MCC housing, aluminium, length 140mm
Control system:	MCC not mounted on side frame. Prepared for fixation in distance up to 3 m from the drive.
Without control system:	With drive unit similar type for ACS50 without pulse encoder, drive available for left and right hand (if not specified: right side), safety control relay for the safety edge and brake rectifier supplied separately. Cable length = daylight height, other length available as option. Distance > 3 m from drive are delivered with additional junction box. You will get only a declaration of incorporation instead of a CE-Declaration.
Power supply:	<b>Without control system</b> as standard ACS50
Power supply:	<b>ACS50:</b> (with transformer possible) 3/(N)/PE 440V (±10%), 50Hz,                   6,3A fuse internal 3/(N)/PE 480V (±10%), 50Hz,                   6,3A fuse internal 3/(N)/PE 500V (±10%), 50Hz,                   6,3A fuse internal
Power supply:	<b>ACS50 UL or without control system (UL version):</b> (without transformer, <u>only</u> with UL drive unit possible) 3/(N)/PE 230V (±10%), 60Hz 3/(N)/PE 460V (±10%), 60Hz 3/(N)/PE 480V (±10%), 60Hz
Power supply:	<b>MCC:</b> 3/(N)/PE 380V (±10%), 50/60Hz 3/(N)/PE 400V (±10%), 50/60Hz 3/(N)/PE 415V (±10%), 50/60Hz 3/(N)/PE 440V (±10%), 50/60Hz 3/(N)/PE 460V (±10%), 50/60Hz 3/(N)/PE 480V (-10%/+5%), 50/60Hz
Power supply:	<b>MCC:</b> (with transformer possible) 3/(N)/PE 220V (±10%), 50Hz 3/(N)/PE 230V (±10%), 50Hz 3/(N)/PE 500V (±10%), 50Hz



<b>ASSA ABLOY</b>	<b>Product specification</b> <b>ASSA ABLOY RP300</b>	Doc.-No.	Seite 9
		Version 16 / 2019-01-31	
<b>Product specification</b>			

Power supply: **MCC:**  
(without transformer, only with UL drive unit possible)  
Max. opening / closing speed:  
Up to 240V, up to DW=2,5m x DH=2,5: 2,2/1,3 m/s.  
Up to 240V, above DW=2,5m x DH=2,5: 2,3/1,15 m/s.  
From 460V, up to DW=2,5m x DH=2,5: 2,2/1,75 m/s.  
From 460V, above DW=2,5m x DH=2,5: 2,3/1,55 m/s.  
3/(N)/PE 208V (±10%), 60Hz, max. door size 3000x3000  
3/(N)/PE 220V (±10%), 60Hz  
3/(N)/PE 230V (±10%), 60Hz  
3/(N)/PE 240V (±10%), 60Hz  
3/(N)/PE 460V (±10%), 60Hz  
3/(N)/PE 480V (-10%/+5%), 60Hz  
Option to supply the MCC from a single phase mains power supply is not available

Heater at drive unit: 380V-480V, 50W at 400V, controlled heater, no neutral wire required

**Legend:**

2009-06-15	pc	new created
2009-09-30	pc	door supports, X-Level added
2010-02-16	stf	Resistance to water penetration, air permeability, heat transition coefficient added.
2010-11-24	pc	RollTex Original Grey - paintable on request added. Min. Door height for Windows, min. dimension from vision panel /Window level to bottom, max. Height of vision panel elongated sealing lip for prerunning photocell added. Chain drive: combination with Door supports is not possible. Side/position of Display mounted on side frame depends on Daylight Height. Cable length 10m and 30m added. Power supply: MCC without internal Fuse.
2011-05-10	wue	Limited the cable length with ACS50 and Schmersal magnetic switch to max. 7m. Added option heater at drive unit.
2012-06-01	stf	ASSA ABLOY Logo integrated
2013-02-13	stf	LED traffic light strip, operating temperature, Window for safety switch added and Colors PVC-curtain added
2013-04-05	wue	Added option UL-drive
2014-03-22	pc	Door supports without / with X-Level: Combination with Chain drive or bottom plates is not possible. Option Hand chain operator added.
2015-03-26	wue	Curtain RollTex plus and RollTex Original: Added note: Testet according to TRAV Bottom beam: Added "with finger protection". Control box ACS50: changed cable length from "daylight height" to 3m. Add option safety switch: "1 Allen-Bradley magnetic switch on drive unit side".

<b>ASSA ABLOY</b>	<b>Product specification</b> <b>ASSA ABLOY RP300</b>	Doc.-No.	Seite 10
		Version 16 / 2019-01-31	
<b>Product specification</b>			

Option safety switch "Safety switch and terminal block in MCC extension or interface card" added.

Option Prepared for Safety switch: added "Brackets for Allen-Bradley are delivered".

Drive: Available with ACS50 and MCC (special door in LIP) deleted.

Control box: "MCC extension with terminal block or optional" added.

Option plastic combi box MCC and metal combi box MCC: added "with bracket and cable channel if door is delivered with door support (column) and with MCC at side frame and without MCC display and if combi box on drive side"

Changed Extensionbox MCC: "Integrated terminal block (Extension card optional)".

Without control: Add "brake rectifier".

Power supply: General update, add UL.

Deleted option "Heater at drive unit"

2015-04-22	wue	Add option "Heater at drive unit"
2017-06-12	pc	<p>Safety switch: SIL3 according to IEC61508, SILCL3 according to EN 62061.  Top roll cover: H &lt;2300 is clear (mandatory removed)  Added: (The flexible sealing lip protrudes 40mm into the daylight height)  Terminology photocell / safety photocell set correctly.  Opening / closing speed stand-alone chapter (separate from the control)  Power supply is now listed at standard (without control; same as standard)  Certificates (new added): Internal pendulum test TRAV shifted from the chapter  Door blade (shock absorption of E = 441J added).  Top roll cover for Std./Vario or chain drive: not necessarily is deleted  Without photocell in door line: Only for use in automated processes, <u>without</u> CE-declaration of conformity added.  Pre-running safety photocell: <u>With</u> door line photocell added.  Pre-running safety photocell: <u>Without</u> door line photocell. Only for use in automated processes, <u>without</u> CE-declaration of conformity added.  Safety switch: table added (instead of lots of text).  Power supply: Without control as standard ACS50 (ACS50 postponed to std).</p>
2018-02-01	wue	<p>Option "Safety switch", table: added "Type1" to Schmersal magnetic safety switch.  Option "Safety switch", table: added column "Schmersal Type2 OSSD" and row "control box".</p>
2018-06-14	wue	<p>Add option "Bottom beam: Version A".  Add option "Bottom beam: Version B".</p>
2018-10-29	pc	<p>ACS50 in ASSA ABLOY ACS50, ACS50 UL in ACS50 UL changed.  Bottom beam Version B: Added "Not with ACS50".  Without control system: You will get only a declaration of incorporation instead of a CE-Declaration; added.</p>
2019-01-31	wue	<p>Bottom beam Version A and Version B: Deleted sketches and add pictures.  Door blade alternative 3: Delete NA= Non anti-static. Add Antistatic, <math>R &lt; 3 \times 10^8 \Omega</math> for Orange, Blue and Grey.</p>